



LOVETT
Sales & Lettings

£208,000



32 William Drive, Eynesbury, St. Neots, PE19 2RF

- Cluster home
- Two bedrooms
- Popular location in Eynesbury
- Easy access to A1 & A428
- Schools nearby
- Small garden to side

Full Description

A two bedroom cluster home in a popular location in Eynesbury close to local amenities including One leisure gym, pool and sports facilities as well as Tesco Superstore and Pocket Park walks. The property also is within easy reach of Primary and Secondary Schools plus the A1 & A428. The accommodation comprises; entrance hall, living room and kitchen on the ground floor plus two bedrooms and a bathroom on the first floor. The property benefits from gas radiator heating and UPVC windows. Small garden to side. Allocated parking space. No forward chain.



ENTRANCE HALL

UPVC entrance door leading to entrance hall. Storage cupboard plus cupboard under stairs. Doors kitchen and living room. Radiator. Tiled floor.

KITCHEN

11' 8" x 14' 11" (3.56m x 4.55m)

Fitted kitchen comprising work surfaces with complimentary drawers and cupboards under. Wall mounted cupboards. Single bowl sink with mixer tap and tiled splash backs. Freestanding electric cooker. Plumbing for washing machine. Wall mounted gas boiler. Radiator. UPVC windows to front.



LIVING ROOM

14' 11" x 11' 8" (4.55m x 3.56m)

UPVC bay window to side. Two radiators. Wood flooring. TV and telephone points. Stairs to first floor.

LANDING

Loft access. Doors to bedrooms and bathroom.

BEDROOM ONE

11' 8" x 11' 7" (3.56m x 3.53m)

UPVC window to side. Radiator. Wood flooring.



BEDROOM TWO

11' 8" x 6' 5" (3.56m x 1.96m)

UPVC window to front. Radiator. Wood flooring.



BATHROOM

Three piece suite comprising low level WC, pedestal wash hand basin and panelled bath with shower over. Tiled splash backs and glass screen. Radiator. UPVC window to front.

GARDEN

Garden to side laid to shingle surrounded with mature hedges. Outside store cupboard.

PARKING

Allocated parking space.

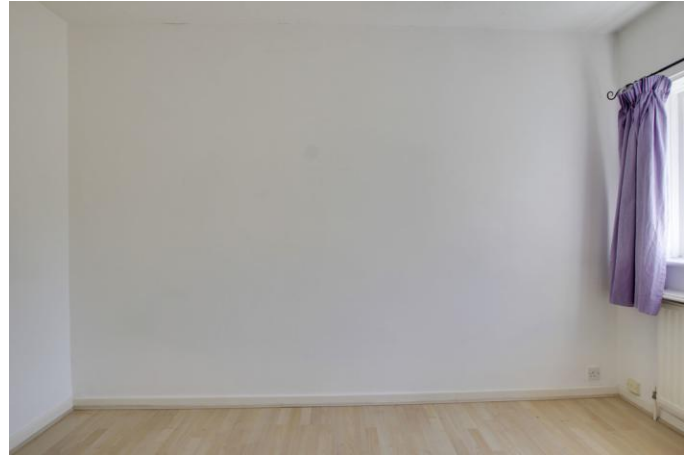

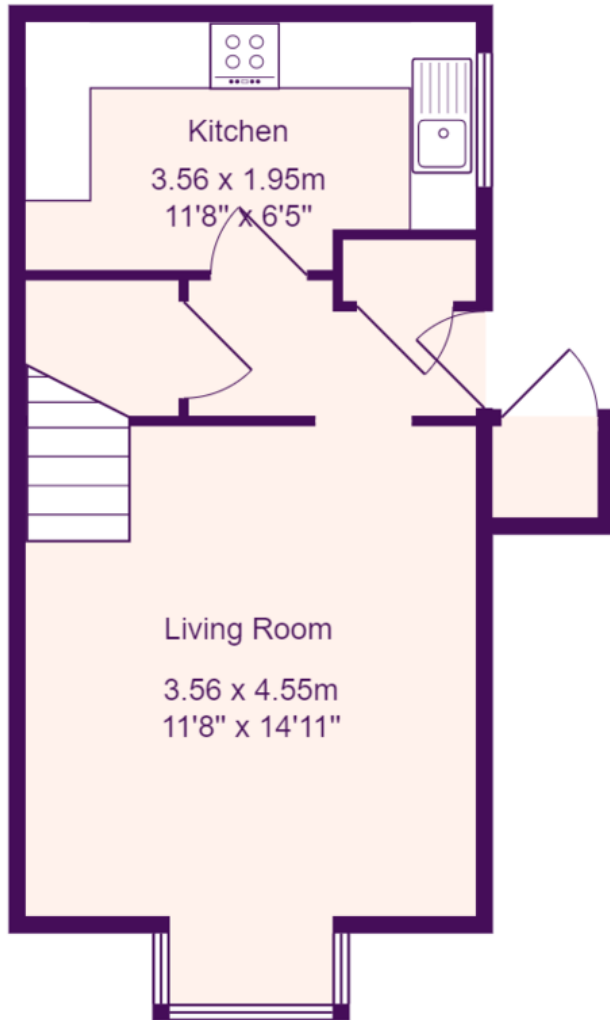

Ground Floor

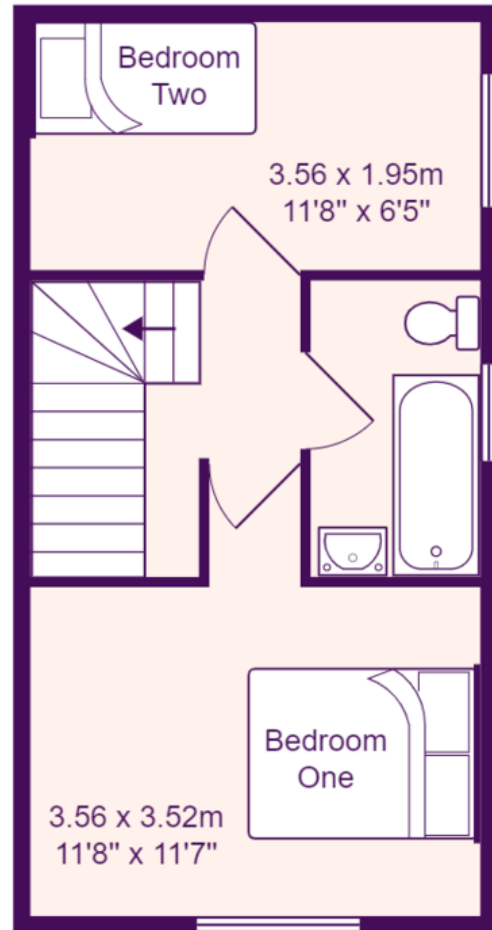

First Floor

Total Area: 51.7 m² ... 556 ft²

All measurements are approximate and for display purposes only