



LOVETT
Sales & Lettings

£150,000



44 Fallow Drive, Eaton Socon, St. Neots, PE19 8QL

- One bedroom cluster home
- Gas radiator heating
- UPVC windows and door
- Open plan garden to front
- Allocated parking space
- Close to local amenities

Full Description

A well presented one bedroom cluster home in a popular location in Eaton Socon within walking distance of local amenities. The property is within easy reach of the A1 and a mile from St Neots Town Centre. The accommodation comprises living room, and kitchen on the ground floor and bedroom and bathroom on the first floor. The property benefits from gas radiator heating and UPVC windows and door. Open plan garden to front. Allocated parking space. No forward chain.

LIVING ROOM

12' 6" x 10' 0" (3.81m x 3.05m)

UPVC Bay window to front. Radiator. Wood flooring. Stairs to first floor. Doors to kitchen.

KITCHEN

9' 1" x 5' 0" (2.77m x 1.52m)

Fitted kitchen comprising work surfaces with drawers and cupboards under. Wall mounted cupboards. Single bowl sink with mixer tap and tiled splash backs. Electric cooker point. Plumbing for washing machine. Under stairs pantry cupboard. UPVC windows to front.

LANDING

Doors to bedroom and bathroom.

BEDROOM

12' 6" x 9' 4" (3.81m x 2.84m)

UPVC window to front and side. Radiator. Built in cupboard housing gas combi boiler. Loft access.

BATHROOM

Three piece suite comprising low level WC, pedestal wash hand basin and panelled bath with shower over. Tiled splash backs. Radiator. UPVC window to front.

OUTSIDE

Open plan front garden laid mainly to lawn with picket fencing.

PARKING

Allocated parking space nearby.





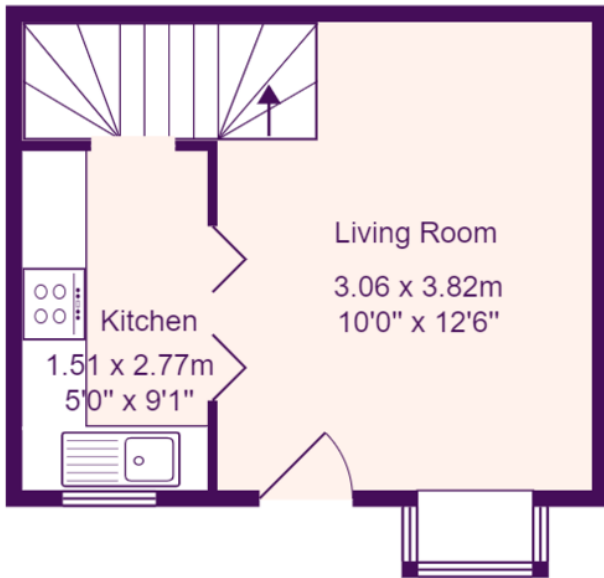

Ground Floor

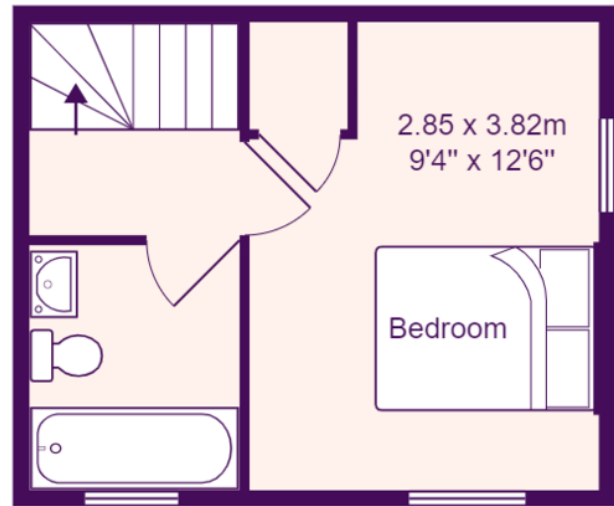

First Floor

Total Area: 36.1 m² ... 388 ft²

All measurements are approximate and for display purposes only