



LOVETT
Sales & Lettings

£225,000



22 Knaresborough Court, Eynesbury, St. Neots, PE19 2SY

- TWO BEDROOM MID TERRACE
- EASY ACCESS TO A1 & A428
- LEISURE FACILITIES NEARBY
- GARAGE AND PARKING SPACE
- WALKING DISTANCE TO PRIMARY AND SECONDARY SCHOOLS
- UPVC WINDOWS AND DOORS

Full Description

A two bedroom mid terrace home in a POPULAR RESIDENTIAL AREA within walking distance of LOCAL GYM, SWIMMING POOL, SQUASH COURTS, SPORTS HALL AND OUTDOOR SPORTS PITCHES. Nearby there is also a large Tesco Extra, primary and secondary schools. The accommodation comprises lounge and kitchen/diner on the ground floor with two bedrooms and bathroom on the first floor. Outside there is a rear garden plus GARAGE AND PARKING SPACE CLOSEBY. The property benefits from UPVC windows. No forward chain. Viewing highly recommended!

ENTRANCE HALL

Fitted door mat. Stairs to first floor. Door to lounge.

LOUNGE

12' 9" x 13' 8" (3.89m x 4.17m)

UPVC window to front. Recess under stairs. TV and telephone point. Warm air vent. Opening through to kitchen.

KITCHEN/DINER

12' 9" x 8' 5" (3.89m x 2.57m)

Fitted kitchen comprising work surfaces with drawers and cupboards under. Wall mounted cupboards. Single bowl sink with mixer tap and tiled splash backs. Plumbing for washing machine. Built in electric oven and four ring hob with extractor fan over. Gas warm air central heating system. UPVC French doors to rear garden.

LANDING

Loft access. Doors to bedrooms and bathroom.

BEDROOM ONE

12' 9" x 12' 4" (3.89m x 3.76m)

UPVC window to front. Built in wardrobe. Cupboard housing hot water cylinder. Additional storage cupboard over stairs. Warm air vent.

BEDROOM TWO

9' 9" x 6' 2" (2.97m x 1.88m)

UPVC window to rear. Warm air vent.

BATHROOM

Three piece white suite comprising low level WC, pedestal wash hand basin and panelled bath with electric shower over. Tiled splash backs. Shaver Socket. UPVC window to rear.



FRONT GARDEN

Mainly laid to lawn with pathway leading to front door.

REAR GARDEN

Mainly laid to lawn with patio area. Access to rear.

GARAGE

Single garage with up and over door. Pitched roof with eaves storage. Additional allocated parking space opposite garage.



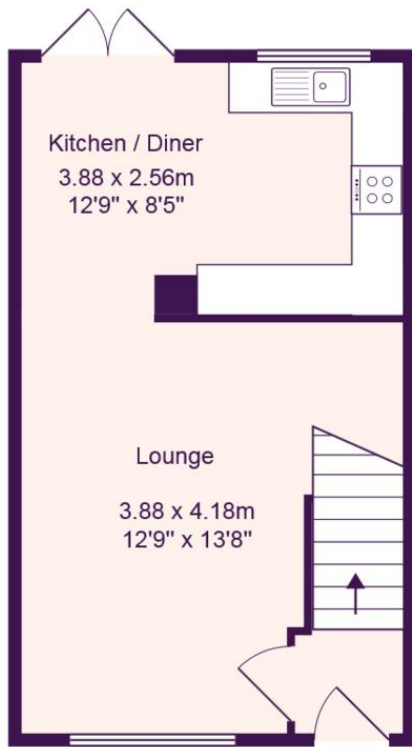

Ground Floor

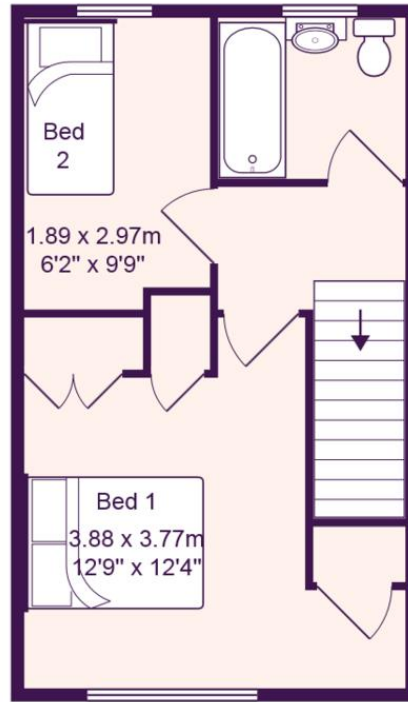

First Floor

Total Area: 52.9 m² ... 569 ft²

All measurements are approximate and for display purposes only