



LOVETT
Sales & Lettings

£165,000



102 Muntjac Close, Eaton Socon, St. Neots, PE19 8QJ

- ONE BEDROOM CLUSTER HOME
- GAS RADIATOR HEATING
- UPVC WINDOWS
- ALLOCATED PARKING SPACE
- POPULAR LOCATION
- SELLING WITH TENANT IN RESIDENCE

Full Description

A one bedroom Q Type cluster home in a popular location in Eaton Socon. The property comprises living room and kitchen on the ground floor and a bedroom and a bathroom on the first floor. The property benefits from gas radiator central heating and UPVC windows. Allocated parking Space. No forward chain.

LIVING ROOM

12' 7" x 10' 0" (3.84m x 3.05m)

UPVC bay window to front. Radiator. Stairs to first floor. Door to kitchen.



KITCHEN

9' 1" x 5' 3" (2.77m x 1.6m)

Fitted kitchen comprising work surfaces with drawers and cupboards under. Wall mounted cupboards. Single bowl sink with mixer tap and tiled splash backs. Built in oven and four ring hob with extractor fan over. Plumbing for washing machine. Wall mounted gas boiler. Radiator. Cupboard under stairs. UPVC window to front.

LANDING

Doors to bedroom and bathroom.



BEDROOM

12' 7" x 9' 5" (3.84m x 2.87m)

UPVC windows to front and side. Radiator. Storage cupboard.

BATHROOM

Three piece suite comprising low level WC, pedestal wash hand basin and panelled bath with shower over. Tiled splash backs. Heated towel rail. Extractor fan. UPVC window to front.

OUTSIDE

Open plan garden to front and an allocated parking space.

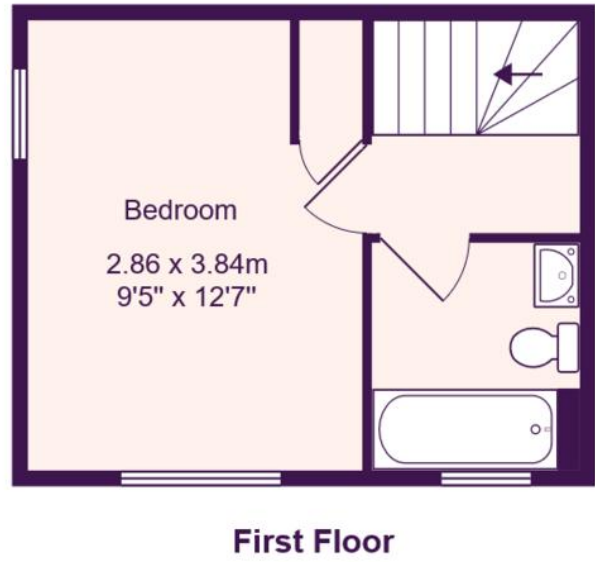
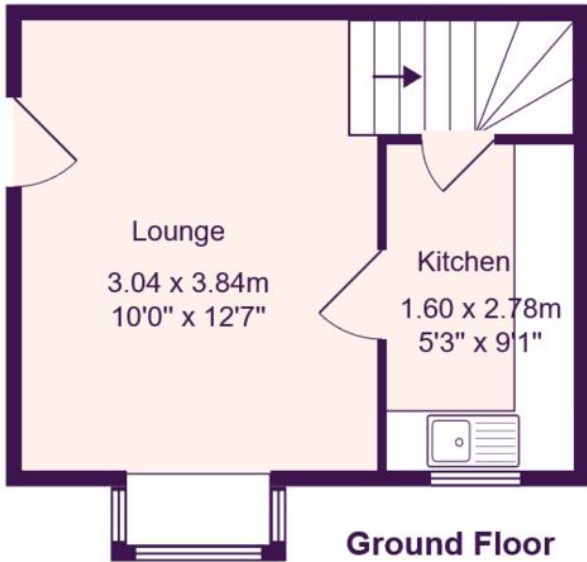

Total Area: 37.0 m² ... 398 ft²

All measurements are approximate and for display purposes only

EPC GRAPH

