



**LOVETT**  
Sales & Lettings

£115,000



## 62 Ashton Gardens, Huntingdon, PE29 7HQ

- RENOVATION REQUIRED
- FULL COSMETIC REFURBISHMENT NEEDED
- HUNTINGDON TOWN CENTRE LOCATION
- ONE BEDROOM
- FREEHOLD CLUSTER HOME
- ALLOCATED PARKING SPACE

## Full Description

A one bedroom cluster home in need of full cosmetic refurbishment situated close to Huntingdon Town Centre and half a mile from the railway station. The accommodation comprises; entrance porch, living room with walk in bay window and kitchen on the ground floor. The first floor has one double bedroom and a bathroom. Allocated parking space. Open plan garden to front. No forward chain!

### LIVING ROOM

13' 10" x 10' 5" (4.22m x 3.18m)



### KITCHEN

8' 2" x 6' 6" (2.49m x 1.98m)



### BEDROOM

11' 8" x 10' 7" (3.56m x 3.23m)

### BATHROOM

### OUTSIDE

Open plan garden and allocated parking space.







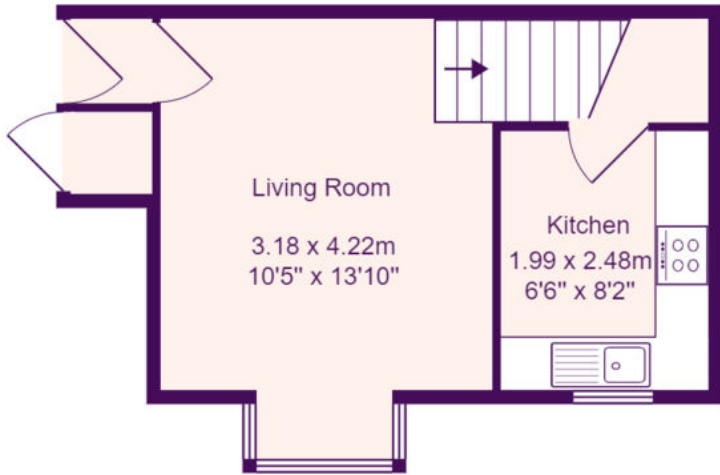

**Ground Floor**

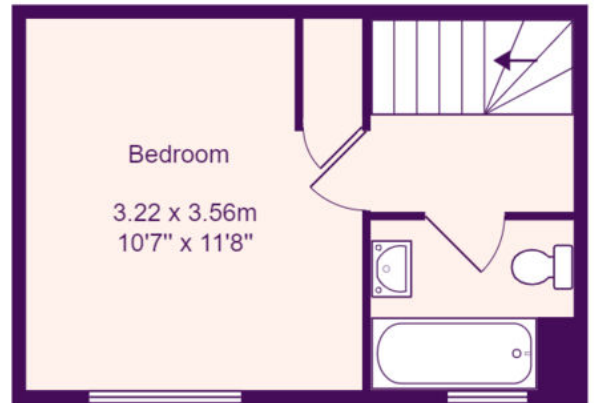

**First Floor**

Total Area: 39.7 m<sup>2</sup> ... 427 ft<sup>2</sup>

All measurements are approximate and for display purposes only

EPC GRAPH  
%epcGraph\_c\_1\_150%