



8 Ackerman Street, Eaton Socon, St. Neots, PE19 8HR

- CHARACTERFUL COTTAGE
- ONE BEDROOM
- CLOSE TO SHOPS / PUBS / AMENITIES
- COURTYARD & OUTBUILDING
- COSMETIC REFURBISHMENT REQUIRED
- NO FORWARD CHAIN

Full Description

A characterful one bedroom Grade II listed cottage situated close to Eaton Socon Green and within short walking distance to Tesco Express, several pubs/restaurants, bus routes and other local amenities. The accommodation comprises living room, kitchen shower room on the ground floor with a bedroom and dressing room on the first floor. Externally there is an open plan courtyard to the rear with two large storage sheds/studio. The property is in need of some cosmetic refurbishment. The roof has recently been replaced. Electric heaters. No forward chain. Viewing highly recommended



LIVING ROOM

13' 2" x 9' 9" (4.01m x 2.97m)

KITCHEN

9' 6" x 7' 3" (2.9m x 2.21m)

BEDROOM ONE

13' 2" x 11' 5" (4.01m x 3.48m)

DRESSING ROOM / BEDROOM TWO

10' 1" x 7' 3" (3.07m x 2.21m)





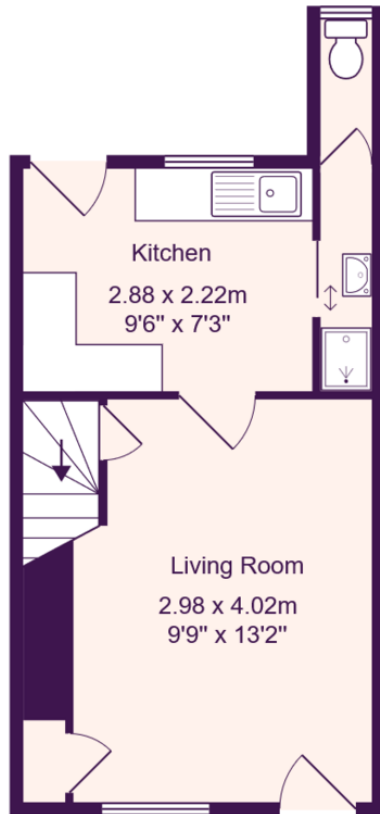

Ground Floor

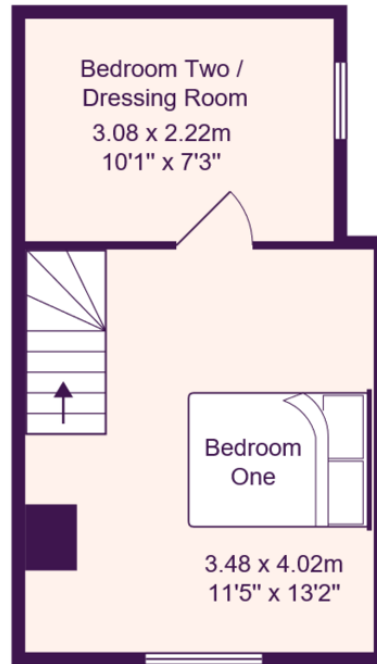

First Floor

Total Area: 43.8 m² ... 471 ft²

All measurements are approximate and for display purposes only